

**Helensburgh & Lomond
Capital 2015/16
Location Plans**

Capital 2015/16 - Helensburgh & Lomond
A814 East Clyde Street

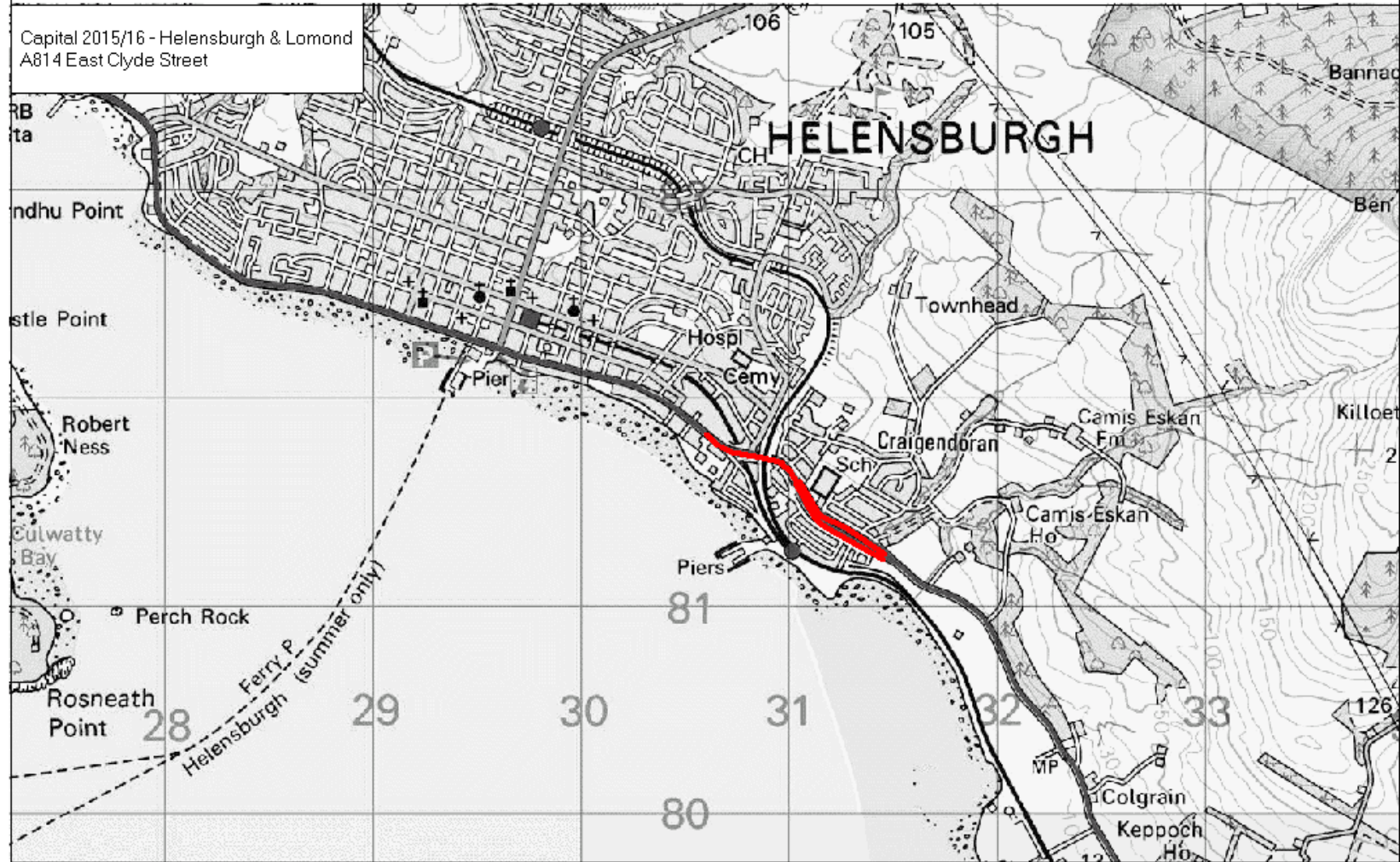

Scale 1:25000

Based upon OS 1:50000 Raster (5x5km) with the permission of the controller of Her Majesty's Stationery Office ©

Capital 2015/16 - Helensburgh & Lomond
A814 Finnart Depot

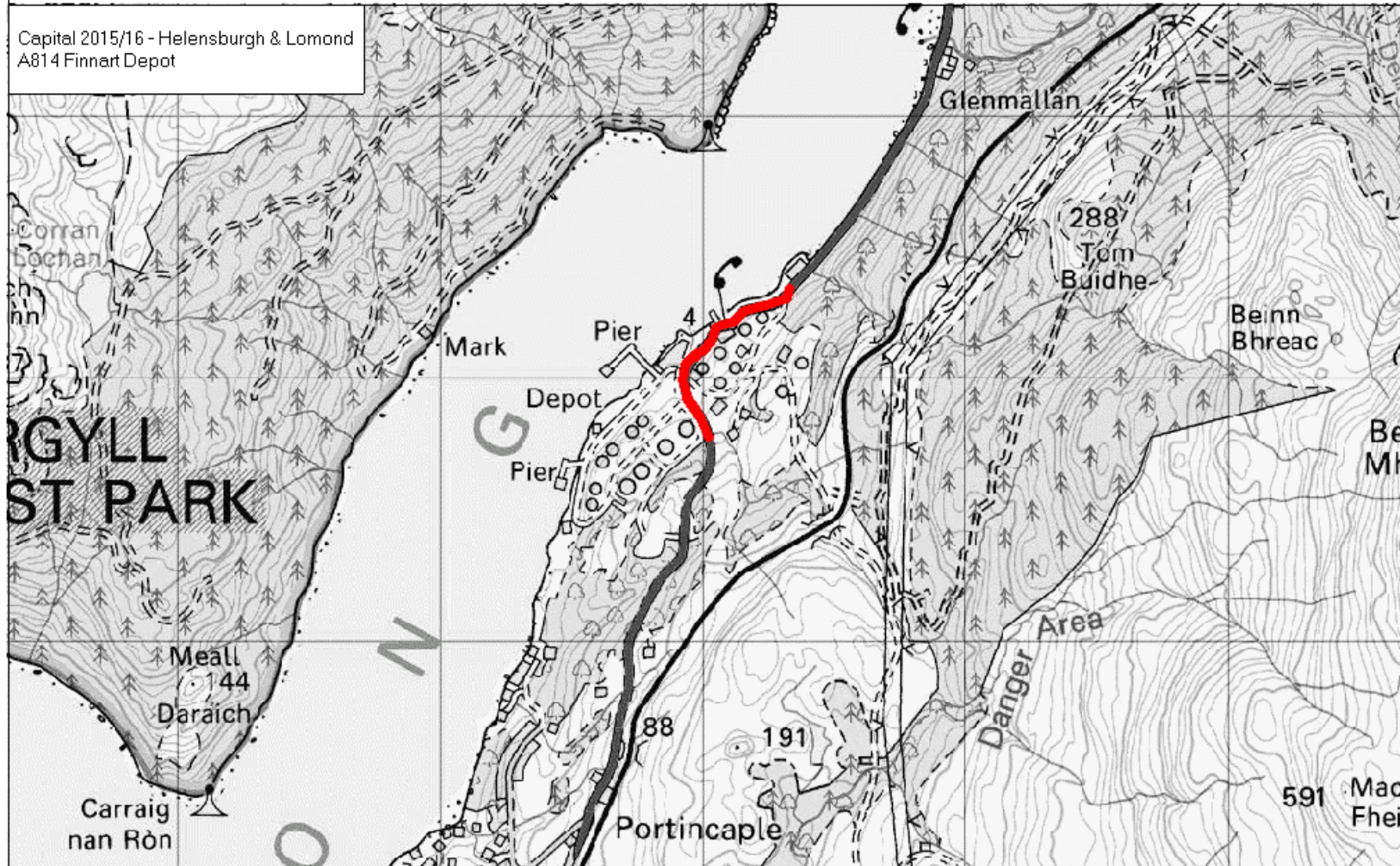

Scale 1:20000

Based upon OS 1:50000 Raster (5x5km) with the permission of the controller of Her Majesty's Stationery Office ©



Capital 2015/16 - Helensburgh & Lomond
A814 Gareloch Road (Pier Rd to Rhu Rd Higher)

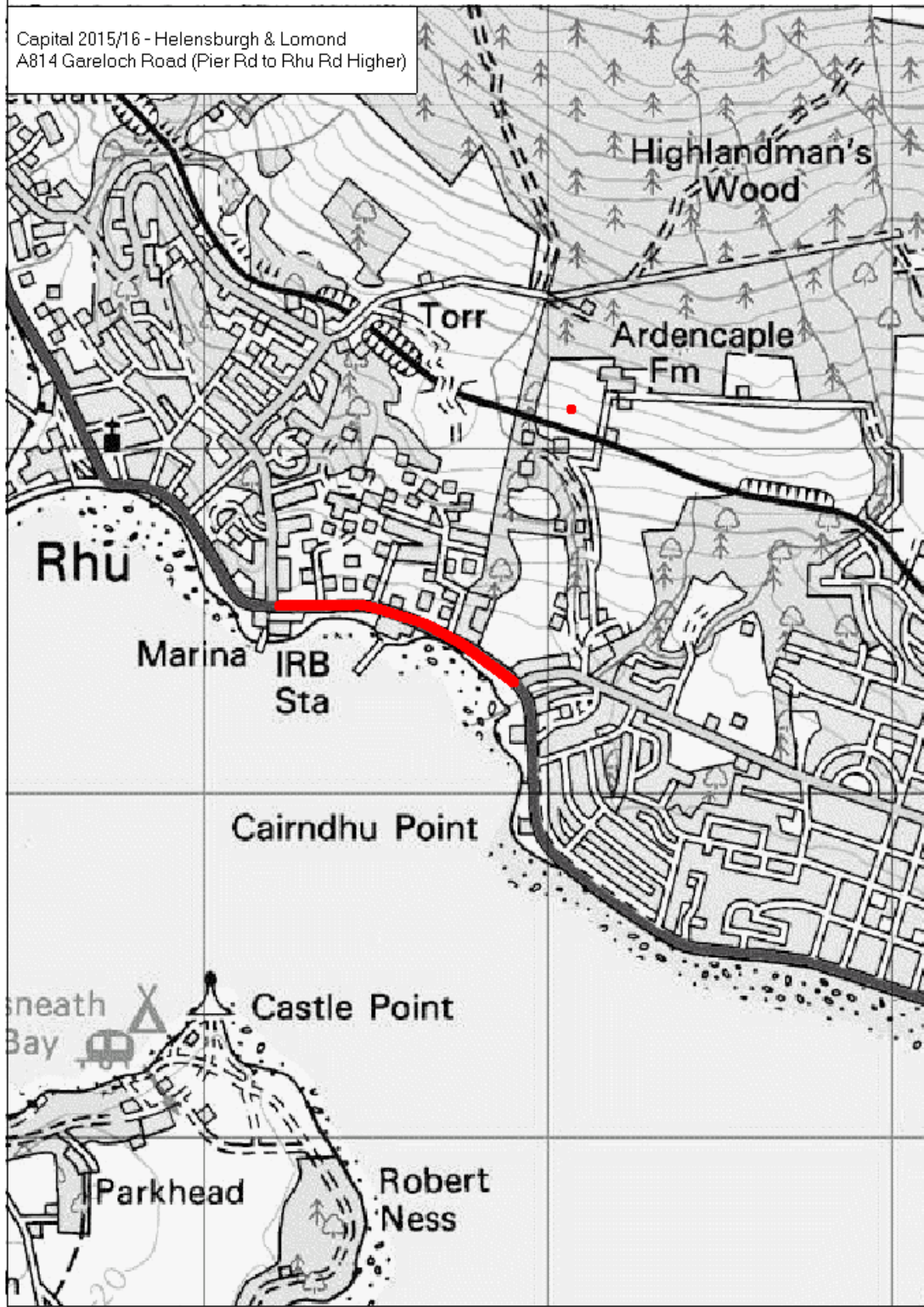

Capital 2015/16 - Helensburgh & Lomond
A814 Glenmallan North

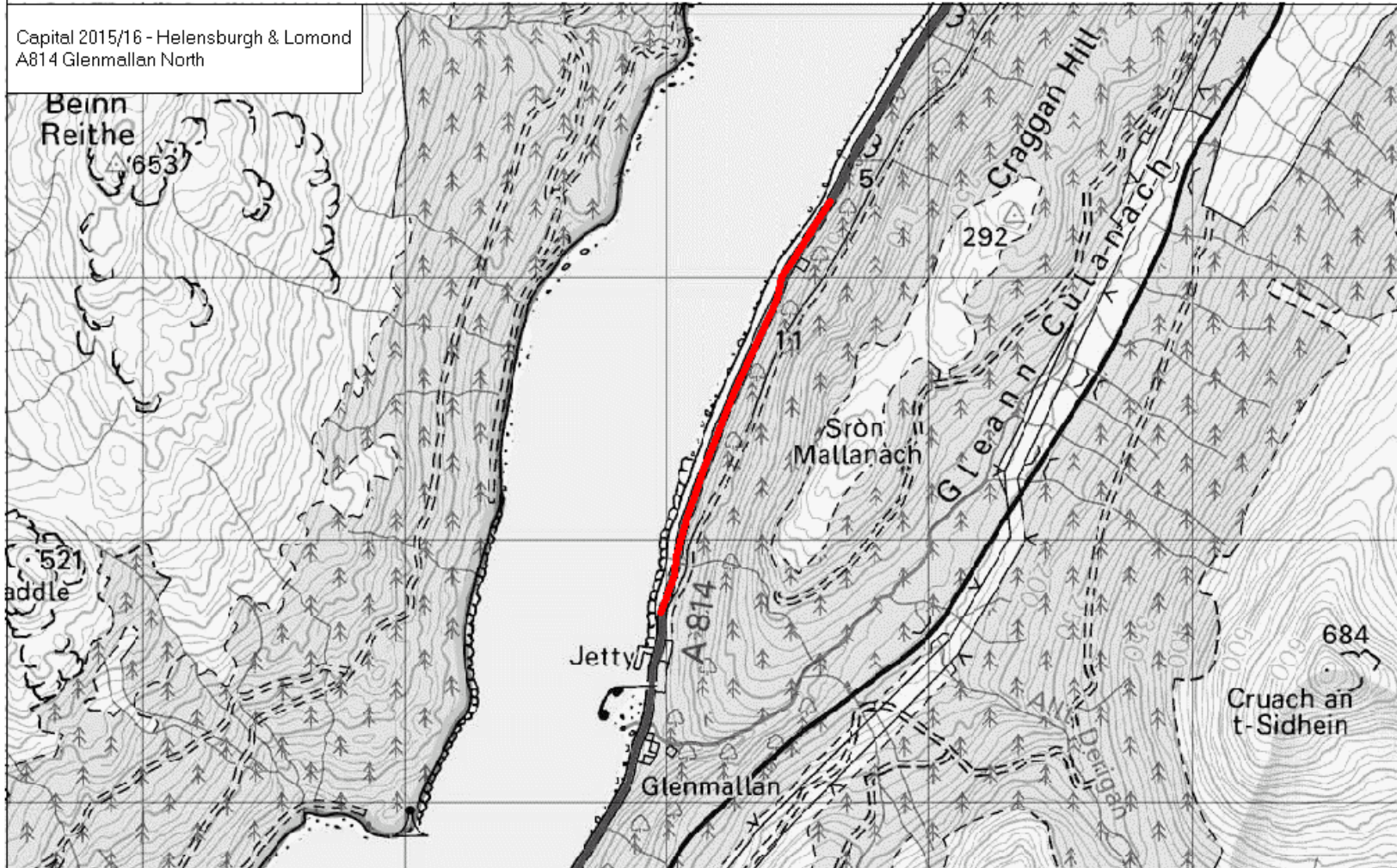

Scale 1:20000

Based upon OS 1:50000 Raster (5x5km) with the permission of the controller of Her Majesty's Stationery Office ©



Capital 2015/16 - Helensburgh & Lomond
Morelaggan Slip Site South

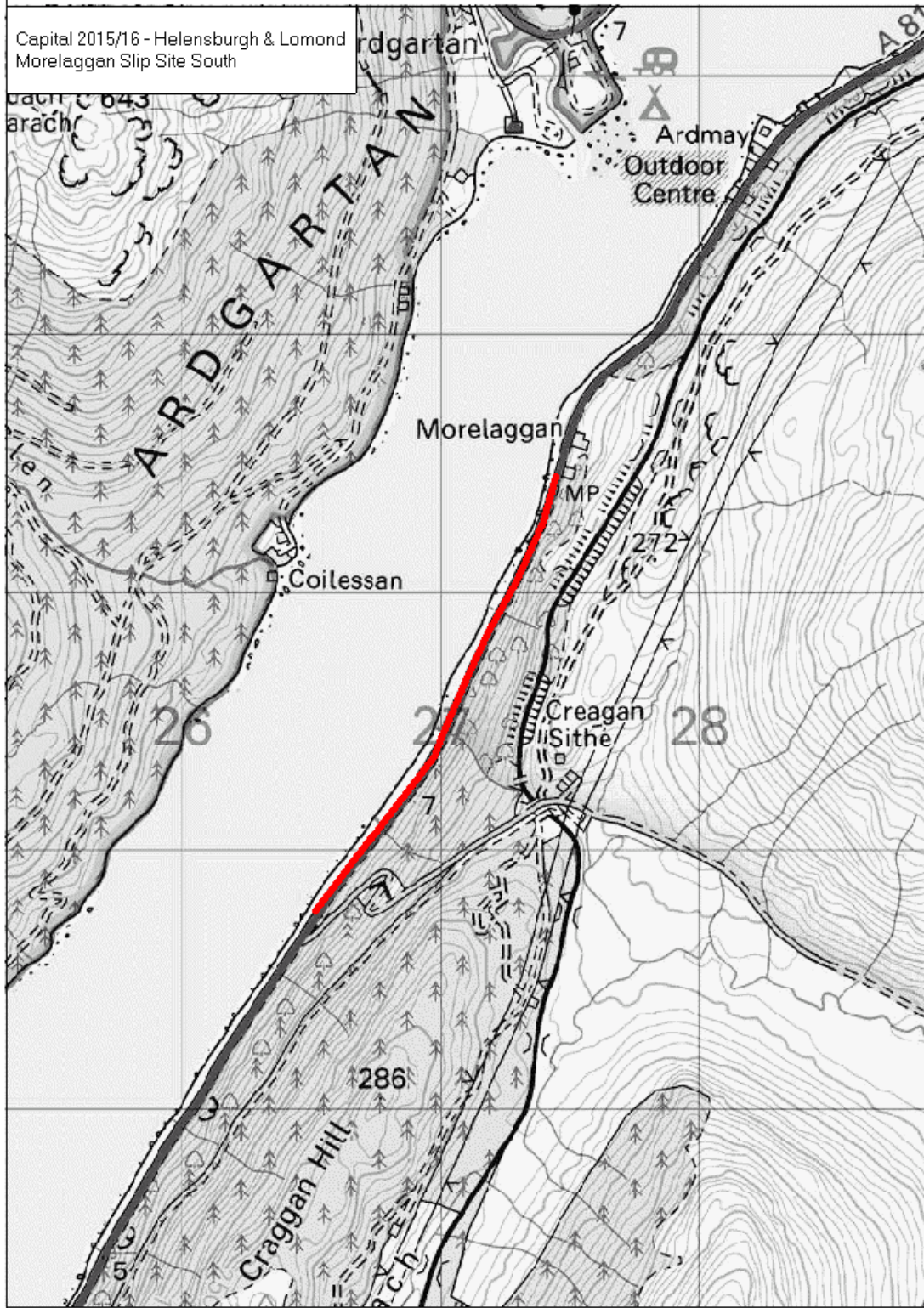

Scale 1:20000

0 1km.

Based upon OS 1:50000 raster (6/5km) with the permission of the controller of Her Majesty's Stationery Office ©



Capital 2015/16 - Helensburgh & Lomond
A814 Tighness to Morelaggan

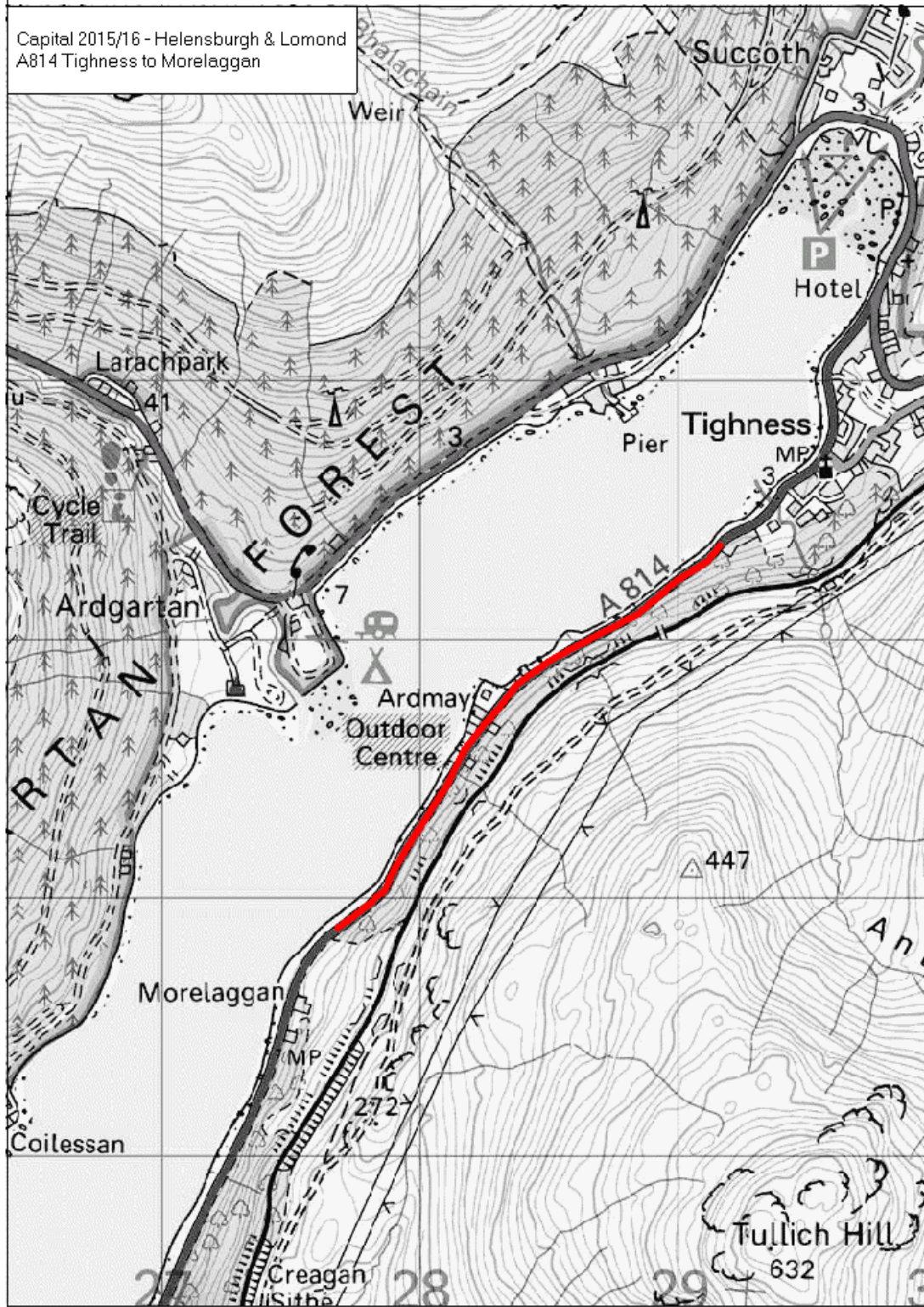

Capital 2015/16 - Helensburgh & Lomond
A818 Glen Fruin to Crosskeys Roundabout

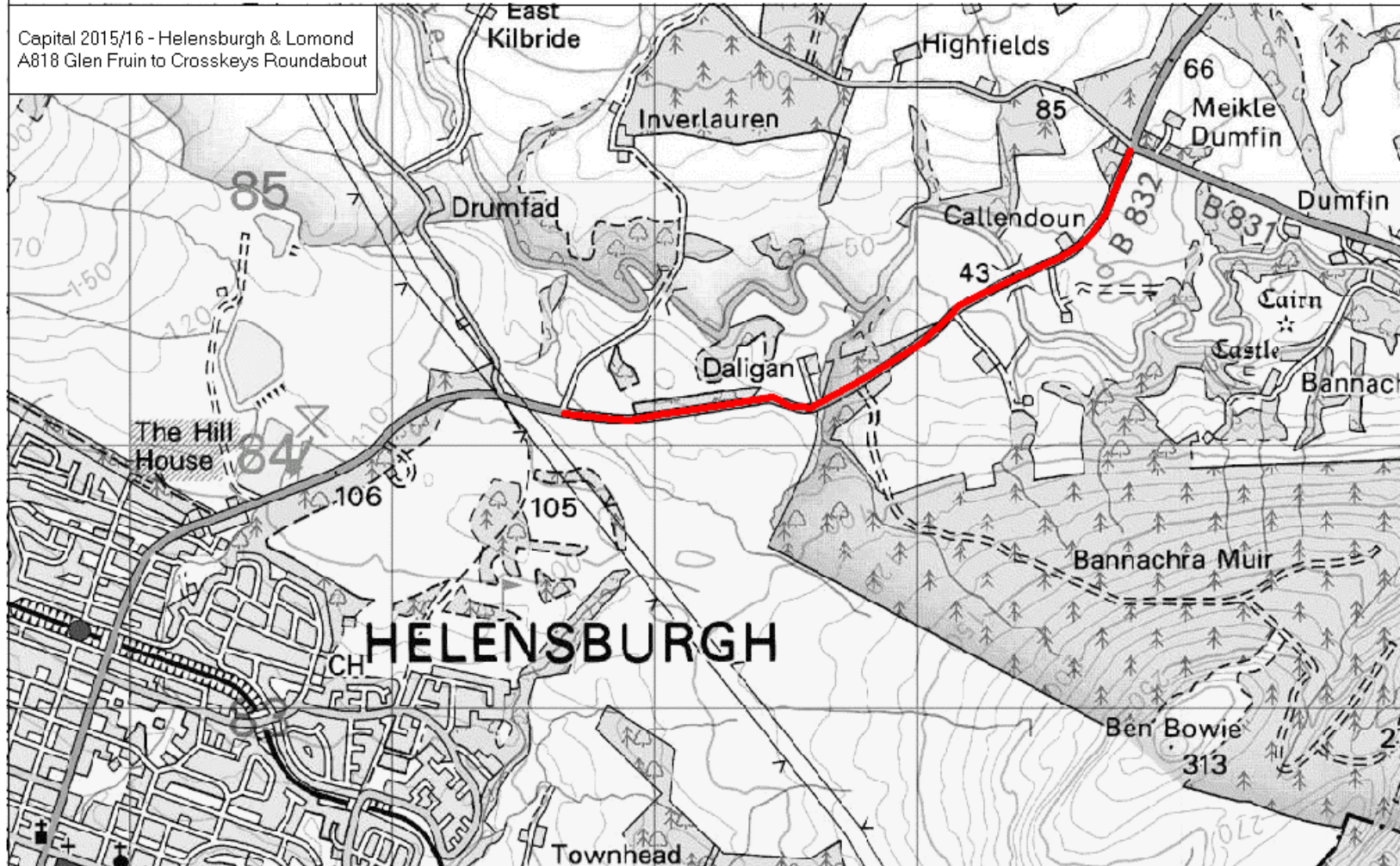

Scale 1:20000

Based upon OS 1:50000 Raster (5x5km) with the permission of the controller or Her Majesty's Stationery Office ©



Capital 2015/16 - Helensburgh & Lomond
B833 Peaton Road to Coulport Roundabout

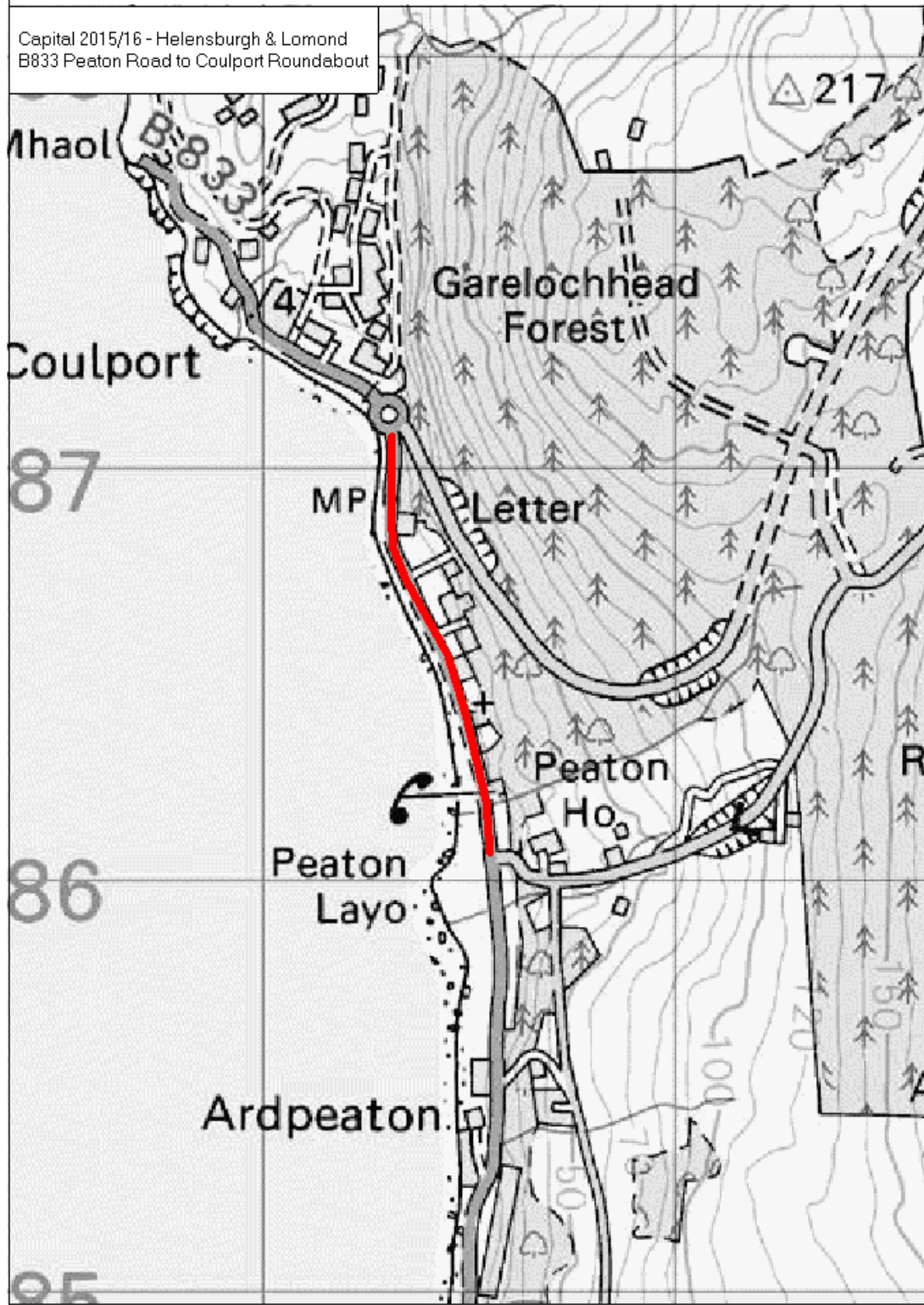

Scale 1:12500

0 500m.

Based upon OS 1:50000 Raster (6/5km) with the permission of the controller of Her Majesty's Stationery Office. ©



Capital 2015/16 - Helensburgh & Lomond
B833 / B872 Junction to Whistlefield R'about



Scale 1:20000



Based upon OS 1:50000 raster (6/5km) with the permission of the controller of Her Majesty's Stationery Office ©



Capital 2015/16 - Helensburgh & Lomond
U101 East King Street



Scale 1:10000

Based upon OS data with the permission of the controller of Her Majesty's Stationery Office ©

0 400m.



Capital 2015/16 - Helensburgh & Lomond
U229 Old Luss Road, Helensburgh

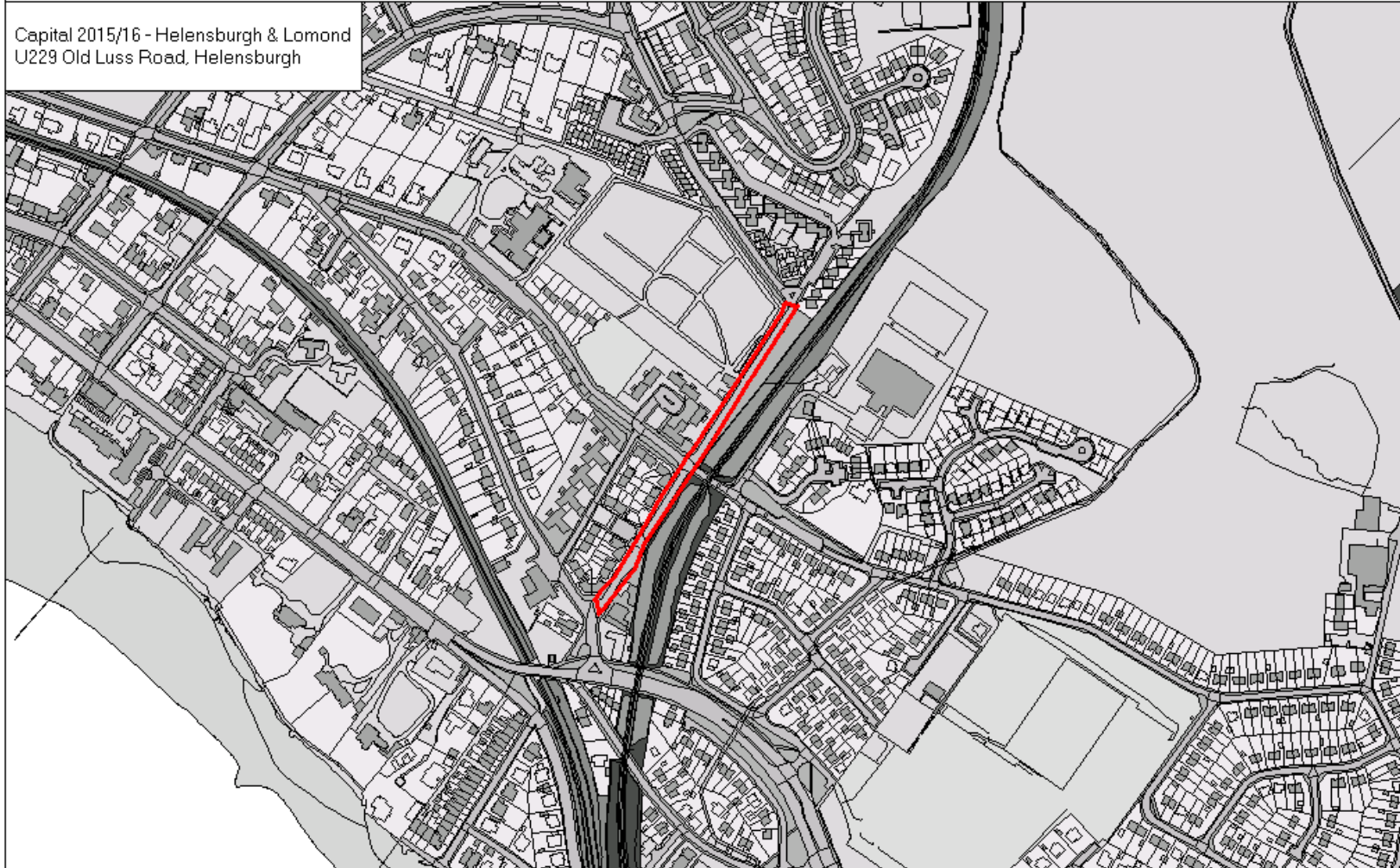

Scale 1:5000

Based upon OS data with the permission of the controller of Her Majesty's Stationery Office ©

0 200m.



Capital 2015/16 - Helensburgh & Lomond
U268 South King Street, Helensburgh

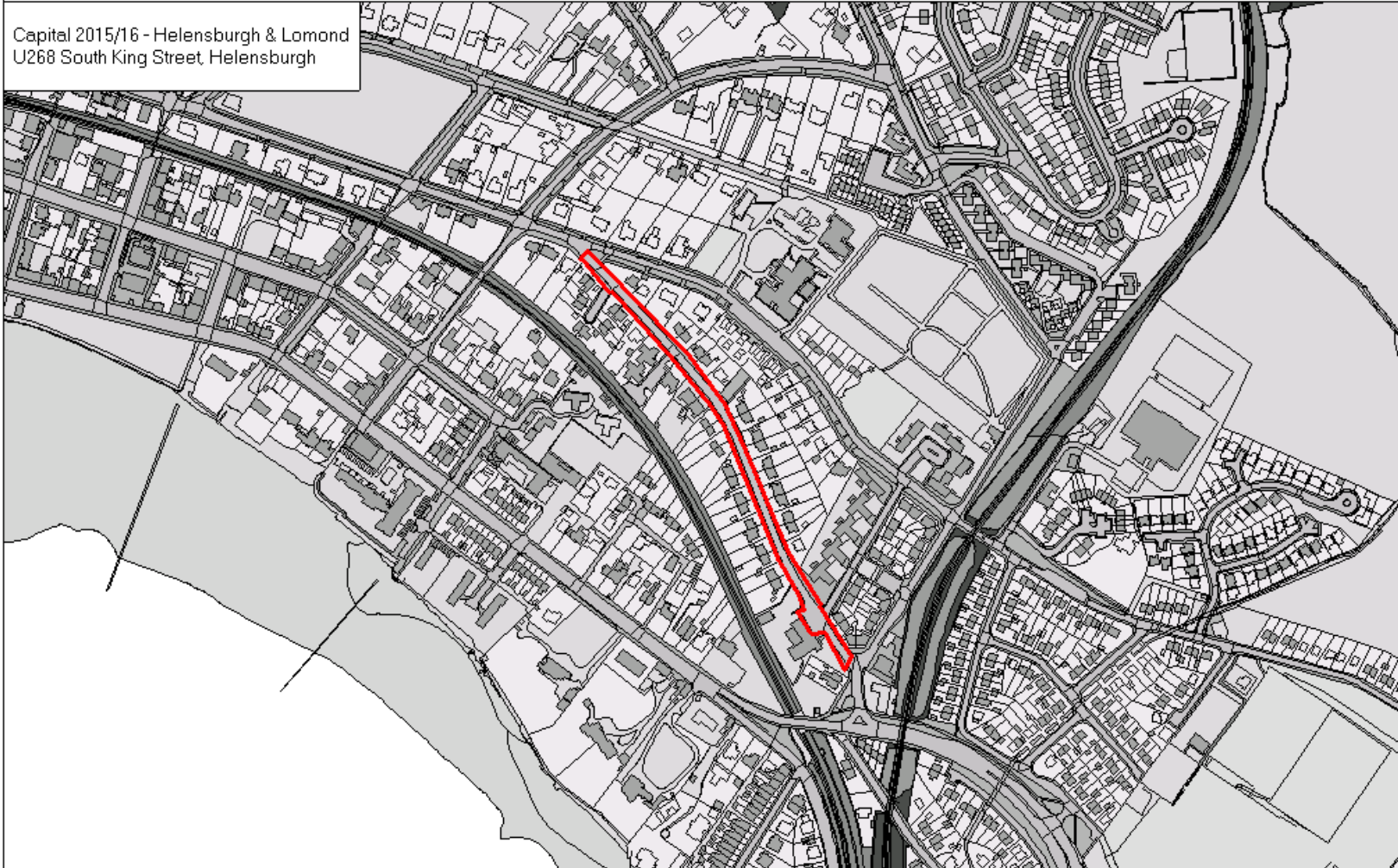

Scale 1:5000

Based upon OS data supplied with the permission of the controller of Her Majesty's Stationery Office ©

0 200m.

